

CP 130-LS

BUITENKADER
DORMANT
OUTER FRAME
BLENDRAHMEN

TWIN



	$\frac{A}{dm^2/m}$	$\frac{P}{dm^2/m}$	L_m	$I_x \text{ cm}^4$	$W_x \text{ cm}^3$	ax mm	$I_y \text{ cm}^4$	$W_y \text{ cm}^3$	ay mm	X Y X 0
006.1901.XX	48.30	21.8	7.00/4.00	123.602	17.603	70.22	9.783	5.152	18.01	

006.1901.XX

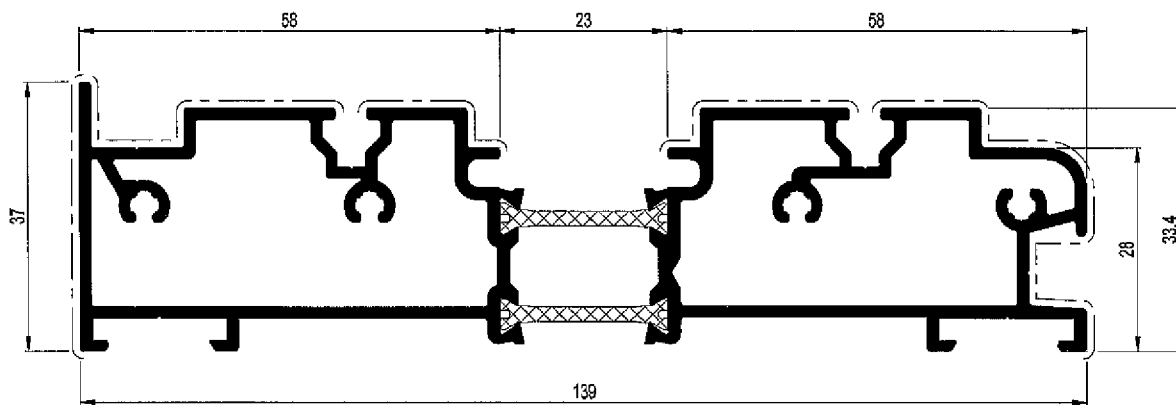

	006.1901.XX	
	052.5315.- (4x)	097.U800.00 of-or-order 097.0061.00

	$\frac{A}{dm^2/m}$	$\frac{P}{dm^2/m}$	L_m	$I_x \text{ cm}^4$	$W_x \text{ cm}^3$	ax mm	$I_y \text{ cm}^4$	$W_y \text{ cm}^3$	ay mm	
006.1910.XX	50.96	18.7	7.00/4.00	112.741	15.949	68.31	10.540	2.982	17.76	
006.1913.XX	55.45	25.6	7.00/4.00	121.149	16.584	65.95	14.947	4.424	33.79	

006.1913.XX

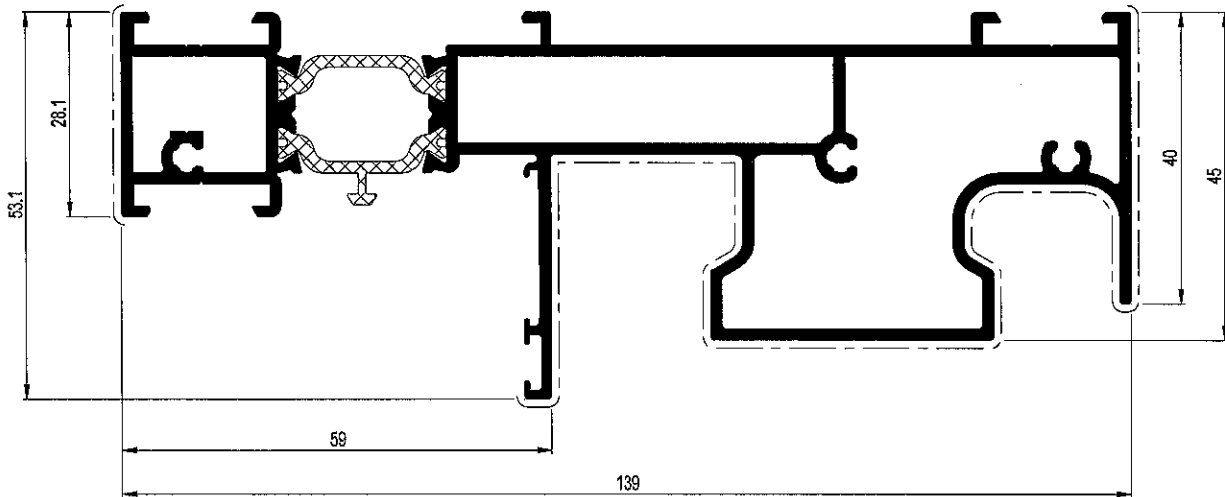

006.1910.XX

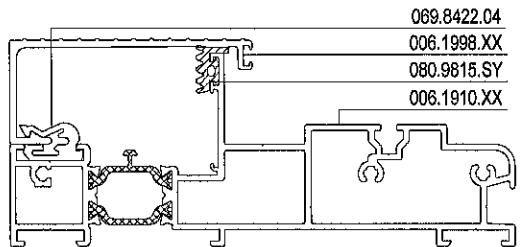
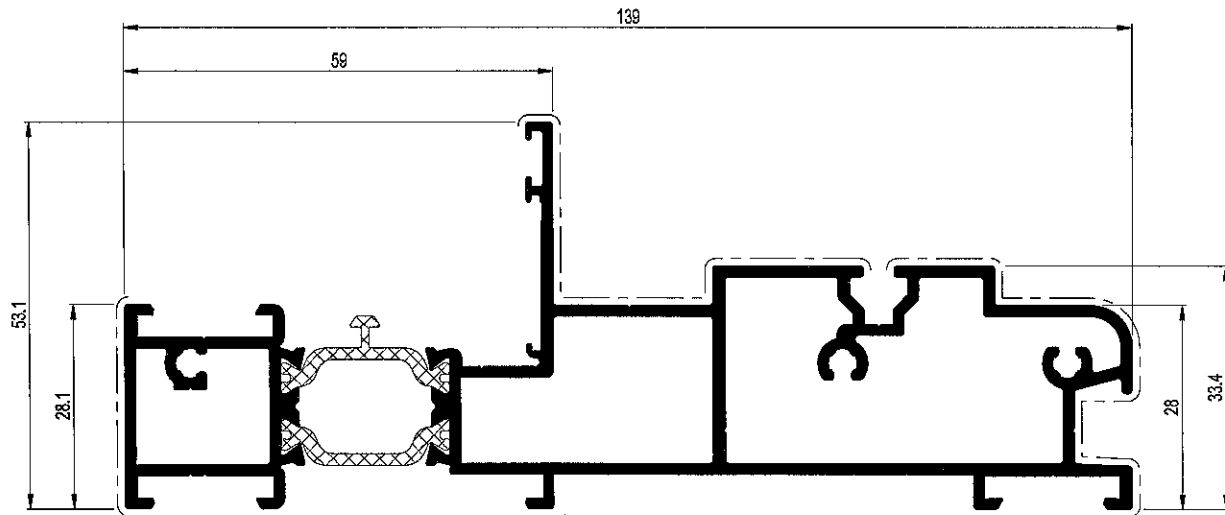

069.8422.04
006.1998.XX
080.9815.SY
006.1910.XX

	006.1910.XX				006.1913.XX		
	052.5315.-- (3x)	097.0051.00			052.5315.-- (3x)	097.0051.00	
	060.8746.00	--			060.8746.00	--	

TRIPLE



	$\frac{A}{dm^2/m}$	$\frac{P}{dm^2/m}$	L_m	$I_x \text{ cm}^4$	$W_x \text{ cm}^3$	ax mm	$I_y \text{ cm}^4$	$W_y \text{ cm}^3$	ay mm	
006.1920.XX	69.46	26.7	7.00	391.382	37.067	105.59	14.475	7.578	17.90	

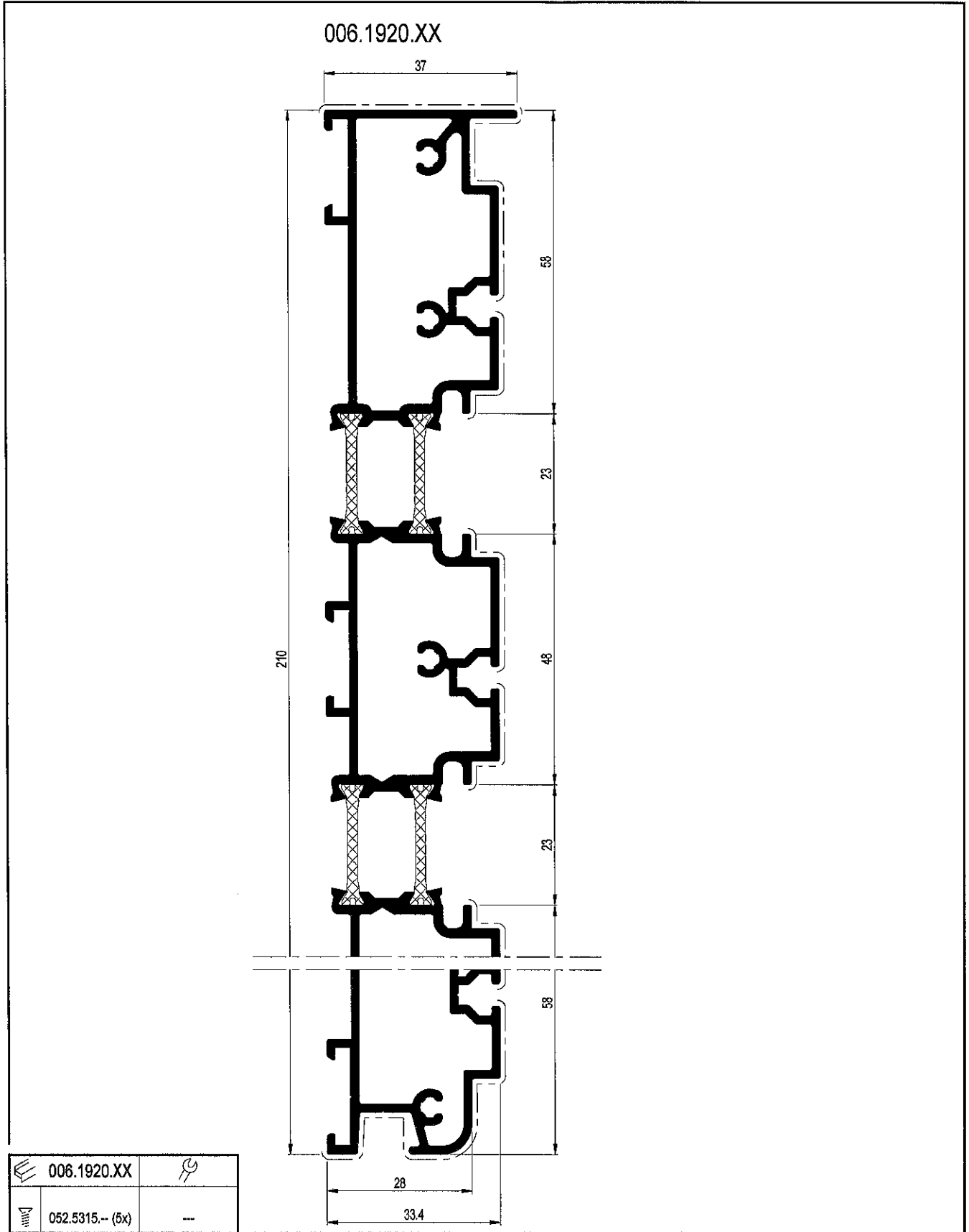

	006.1920.XX	
	052.5315.-- (5x)	--

Profielen
 Perfilés
 Profiles
 Profile